

# Installation Manual

Low Voltage 360° Neon Strip Lights Accessories

Vertical ceiling mounted accessories

CL-ST-NEON25-360D-single end vertical surface mount kit B

Single Ended

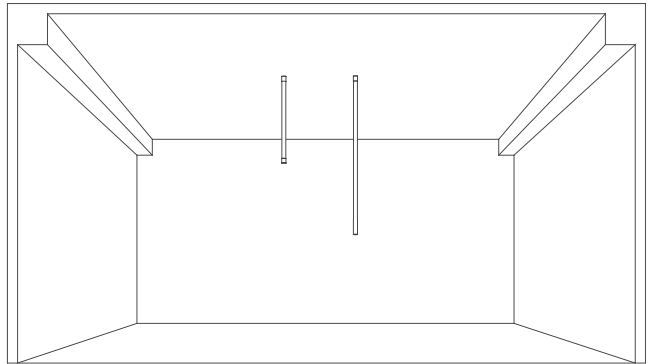

CL-ST-NEON25-360D-Double end vertical pendant kit

Double Ended

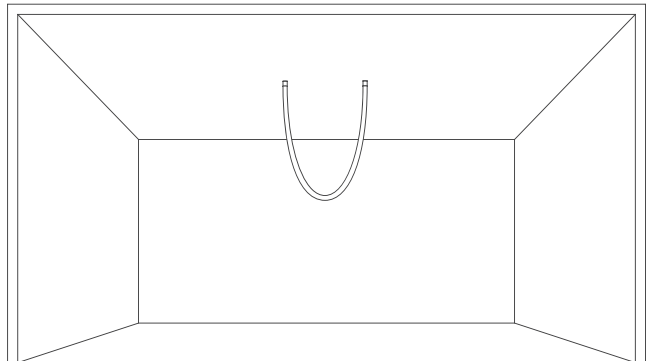

Please read this manual carefully before installation, and install the product in the correct way.  
Please keep it after reading, so that all users of this product can check it at any time.

## Prepare materials- Single Ended



Neon strip



Manual



Rubber plug  
screw



End  
capscrew



Countersunk  
screw



PC tube



Metal  
accessories



Allen wrench



Hexagon  
screw

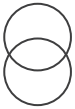

O-ring

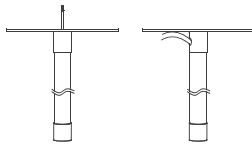

Two installation methods:  
1. Straight outlet 2. Side outlet

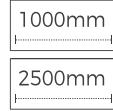

The length of the neon strip and  
PC tube 1m and 2.5m option



## Prepare materials- Double Ended

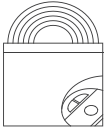

Neon strip



Manual



Rubber plug  
screw



Countersunk  
screw

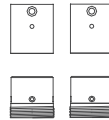

Metal accessories



Allen wrench



Hexagon  
screw

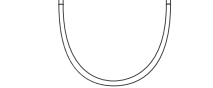

Neon strip can choose 1m, 2.5m, 5m



## Installation tools



Phillips  
screwdriver



Slotted  
screwdriver



Pen

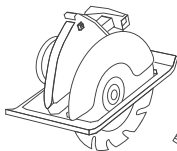

Cutting Machine



Tape measure

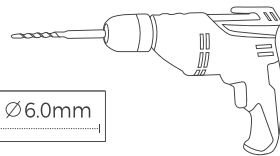

Ø6.0mm

Electric screwdriver (head is ø6.0mm)

# Installation Steps

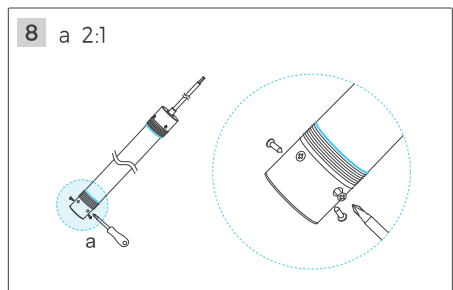
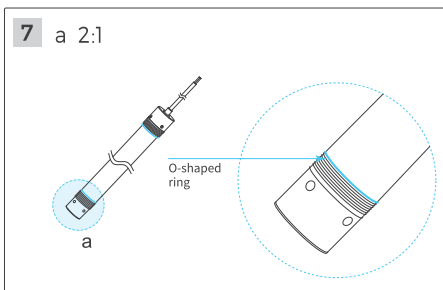
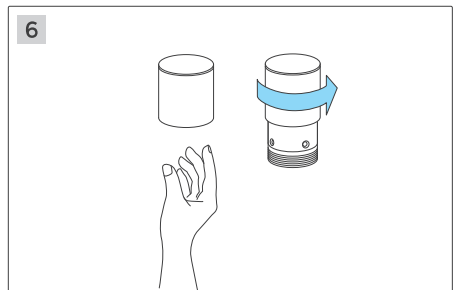
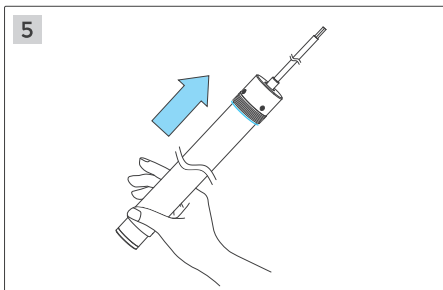
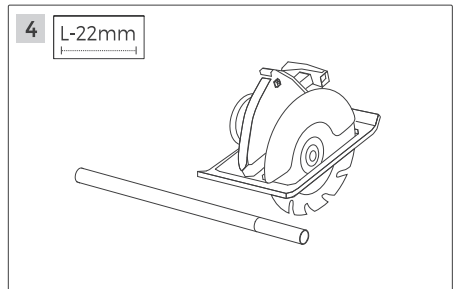
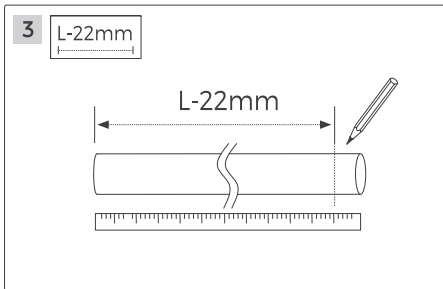
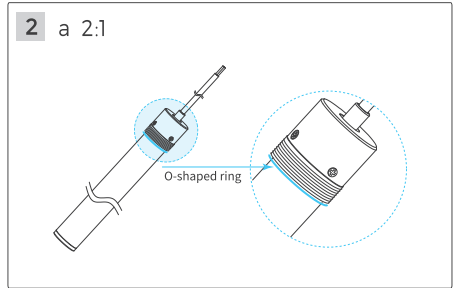
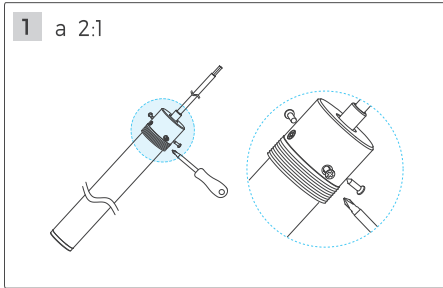

## Installation Steps - Single Ended

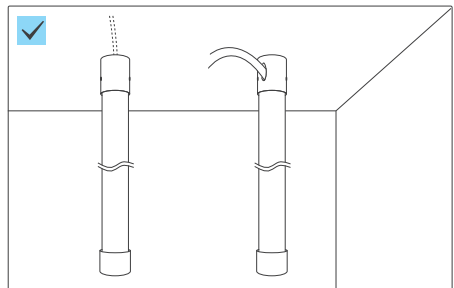
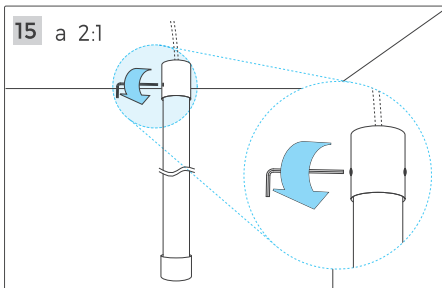
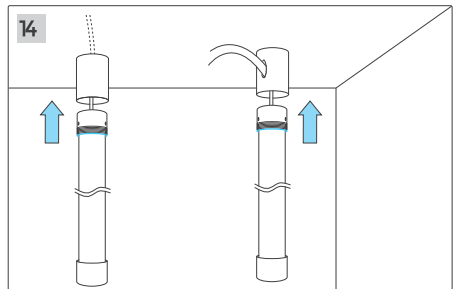
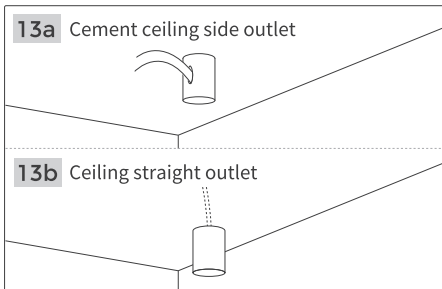
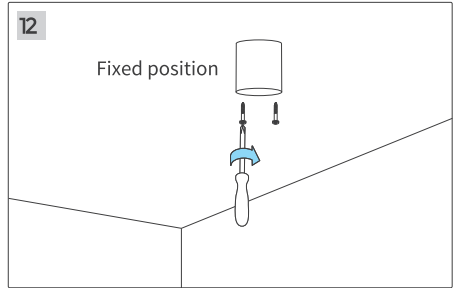
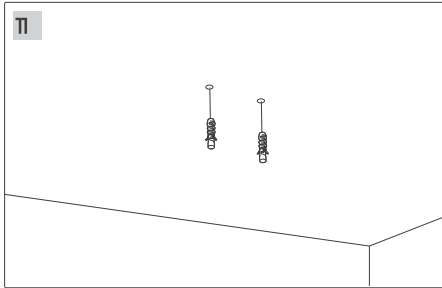
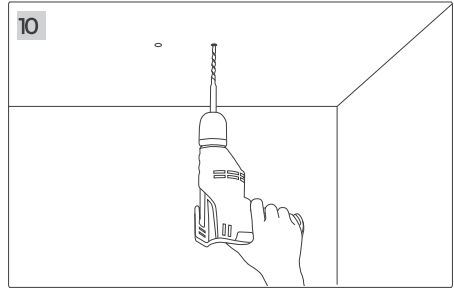
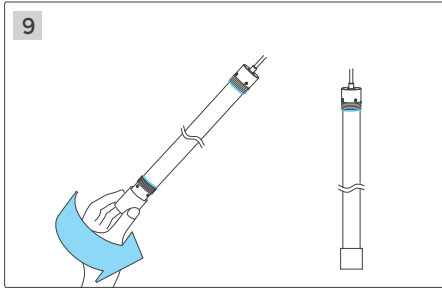

# Installation Steps - Double Ended

