

4-Zone Rainbow Remote CL-AST-S2W+WH

Model No.:S2W+/ S2B+

Product Feature

- 2.4GHz wireless transmission technology offers fast transmission speed, excellent stability and strong anti-interference capability.
- 4 sets of control, supporting the matching of multiple devices, and capable of controlling multiple devices simultaneously
- Supports control of the Miboxer / Mi-Light 2.4G series
- The product offers 16 million color options. The color temperature, brightness, and saturation can all be adjusted according to personal preferences.
- Supports dynamic mode. The remote control can be compatible with multiple controllers (with a control range of 30 meters)
- Installation is simple and it can be magnetically attached.



Product Parameter

Product Name:	2.4GHz Rainbow Remote
Model No.:	S2W+/S2B+
Working voltage:	3V(AAA*2PCS)
Standby consumption:	15 μ A
Transmitting:	6dBm
Protocol:	2.4GHz RF
Modulation:	GFSK
Control Distance:	30M

Working temperature:	-10~40°C
EMC standard:	ETSI EN 301 489-1 V2.2.3 ETSI EN 301 489-3 V2.3.2
Security standard:	EN 61347-2-11:2001+A1: 2019 EN 61347-1: 2015+A1:2021 EN 62493:2015+A1:2022
Radio equipment:	ETSI EN 300 400 V2.2.1
Certification:	CE, EMC, LVD, RED

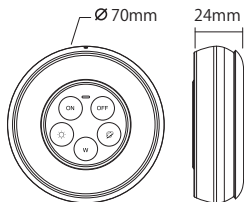

Indication

Touch ring: brightness, saturation, color temperature, RGB use together.
(It turns to adjust brightness by default if remote is not operated for 3 seconds)

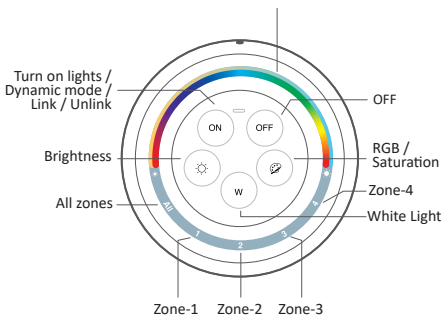

Button Instruction

Master On: ALL

Control all lights which paired with remote

Zones: 1...4

Control lights in individual zones

White: W

Short press W to dim color temperature

RGB/Saturation:

Short press it to change RGB color, double press it continuously to change saturation

Brightness:

Short press it to dim brightness

Switching dynamic mode: ON

Long press "ON" until indicator flashes 2 times and short press "ON" to switch dynamic mode

Attention: stepping out automatically if don't have any operation

Linking Code / Unlinking Code Instructions

Linking Code Instructions

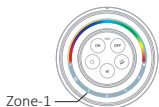

- 1 Click the Zone button you want to pair (e.g., Zone-1)



- 2 Switch off light, after 10 seconds then switch on again.



- 3 Short press " ON " button 3 times within 3 seconds when light on.



- 4 Lights blink 3 times slowly means linking is done successfully.



Linking failed if light is not blinking slowly, Please follow above steps again. (Note: Light that have linked can't link again)

Unlinking Code Instructions

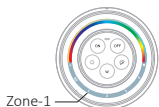

- 1 Click the Zone button you want to pair (e.g., Zone-1)



- 2 Switch off light, after 10 seconds then switch on again.



- 3 Short press " ON " button 5 times within 3 seconds when light on.



- 4 Lights blink 10 times quickly means unlinking is done successfully.



Unlinking failed if light is not blinking quickly, Please follow above steps again. (Note: Light haven't linked that don't need to unlink)

Installation

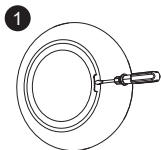

Open battery cover behind remote.

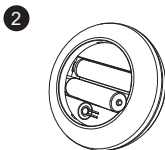

Install battery correctly and close battery cover.

Note: 2*AAA Battery need to buy separately

Group control instruction

Link the lights to different zones for flexible control of lighting in each zone.

Zone control method: Press the zone key (e.g., Zone 1) and then adjust the dimming. Here are some examples of zone control.

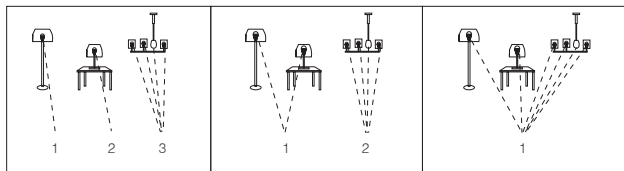

Attention:

1. Countless lights can be added into each zone.
2. One light only can be paired with one sub zone from any remote.

Attention:

1. This remote only support Mi-Light /Miboxer 2.4G product series, kindly review light instruction to check compatibility.
2. Don't use it in humidity or high temperature area, please take out battery if don't use it frequently and keep it in dry or static electricity area
3. Don't use it near metal or strong magnetic area, it will affect signal and lost distance.

